

120D1 12 VDC Power Supply

Installation Guide for PN 701507-120D1 – Two (2) NEC Class 2 Outputs

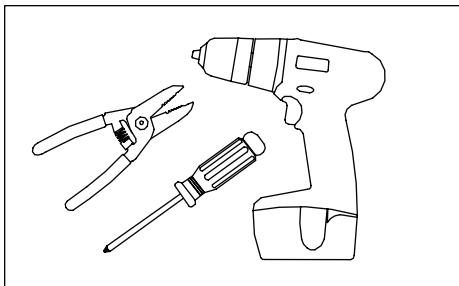

1. **Tools Required:** Wire strippers, drill, and screwdriver.

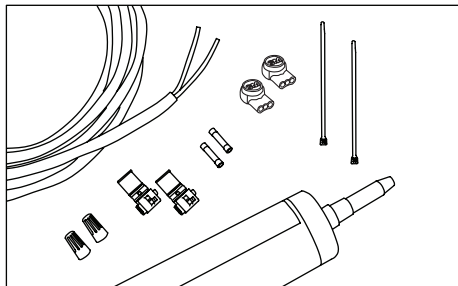

2. **Supplies Required:** Conduit and electrical enclosure for power supply if not placed in a sign made with enclosure rated material, #8 or #10 pan head screws, UL Listed PLTC cable, UL Listed electrical wire connectors (e.g., wirenuts), and silicone.
Europe: Electrical enclosure for power supply, M3 pan head screws, PLTC cable, silicone, and 3M Scotchlok connectors.

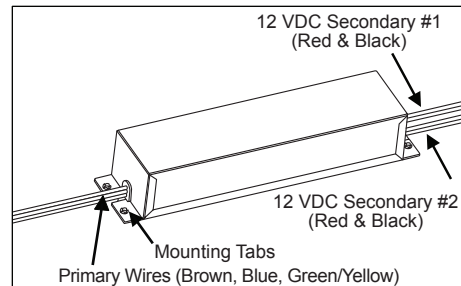

3. **Power Supply:** Identify primary wires, secondary wires, and location of mounting tabs.

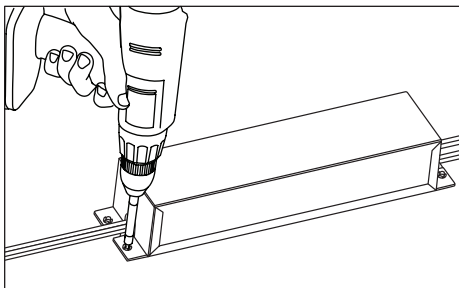

4. **Mount Power Supplies:** Use mounting tab in corners to secure power supply.

NOTE: Power supply operating temperature is -40° to 60° C. Power supply must be mounted in an enclosure (i.e., transformer can/raceway). Power supply spacing to other heat producing components shall be at least 25.4 mm (1 in) from end to end and 101.6 mm (4 in) from side to side. Interconnection of a power supply's outputs will not be accepted. If mounted inside a sign cabinet without a power supply enclosure, UL requires that cabinet and face are made from enclosure rated materials.

Ensure power supplies are not overloaded by verifying each output current is less than 5 DC Amps.

It is recommended to use photocells or light sensors to prolong life of power supply and to keep unit at maximum operating efficiency.

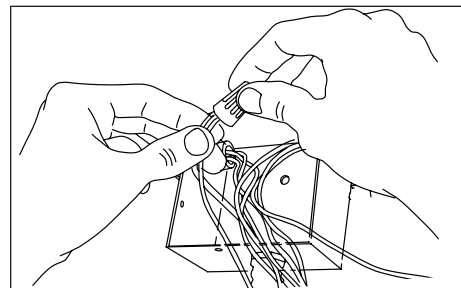

5. **Connect Primary:**
CAUTION: Have a licensed electrician connect primary.

TROUBLESHOOTING

If sign is not functioning properly, check the following:

- Primary voltage is 100-277 VAC
- Each secondary voltage is 12 VDC
- Each output current is 5 Amps or less
- Power supply is not overloaded (see power supply capacity chart in product installation guide or SloanLED.com)
- There are no shorts in secondary wiring
- All secondary connections are RED-TO-RED and BLACK-TO-BLACK
- Power supply outputs are not interconnected.

SloanLED products carry a limited warranty.
For complete details refer to the warranty policy found at SloanLED.com



Some or all of the products shown are covered by U.S. and foreign patents pending and covered by one of more of the following U.S. patents issued: 6776504, 6969179, 7192157, 6932495, 7241031

Customer service and technical support
888.747.4LED (888.747.4533)
SloanLED.com • info@SloanLED.com
P/N 401712 Rev C 2016-05-18

Europe: Customer service and technical support
+31 88 12 44 900
SloanLED.com • Europe@SloanLED.com

