

Installation Guide

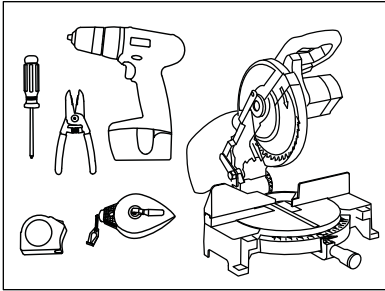

1. Tools required: Measuring tape, wire strippers, drill, screwdriver, chalk line, and miter saw (for custom cut lengths).

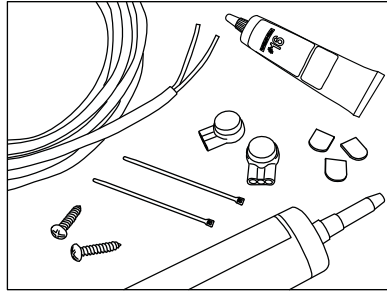

2. Supplies required: PLTC cable, weather proof IDC connectors, cable ties, #6 or #8 pan head screws with suitable threads for mounting surface, silicone (outdoor rated caulk), IPS Weld-On #16, and field cut end caps.

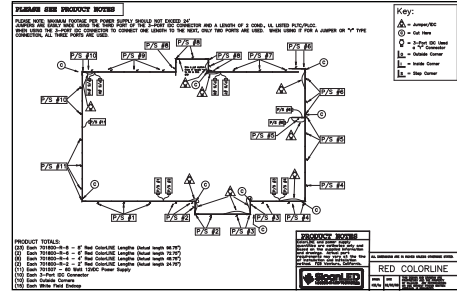

3. Layout: Use an architectural drawing in combination with the Power Supply capacity chart (below) or layout provided by SloanLED (sample above) to determine the number and length of ColorLINE sections and power supplies required for your installation.

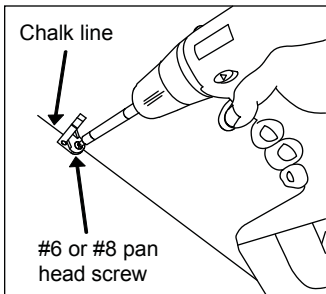

4. Install mounting clips: Snap a chalk line on surface for mounting. Space mounting clips every 12" along chalk line and 1-1/2" from the end of each ColorLINE section. Orient clips so screws are towards center of each ColorLINE section.

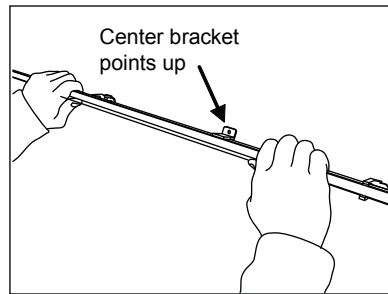

5. Install ColorLINE sections into clips: Snap ColorLINE sections into mounting clips. Use #6 or #8 pan head screws to secure center bracket once all sections are located on the mounting surface.

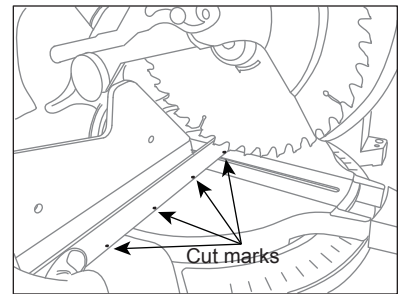

6. Cutting custom lengths: ColorLINE may be cut on any of the black marks (2.4" apart). If a custom length is required, use a miter saw to make a clean, straight cut. **Note:** Perpendicular cuts ONLY. Set miter saw to 0°. No angled cuts.

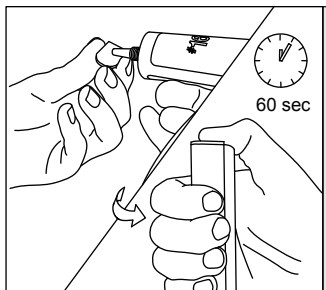

CAUTION: Field end caps must not have any gaps which would allow water penetration. Ensure end cap completely seals the end of the ColorLINE section.

7. Cap custom cut lengths: Clean any burrs and debris from cut end and ensure that any exposed wires are not in contact with each other (trim wires if necessary). Apply IPS Weld-On #16 to entire surface of a ColorLINE field cut end cap and bond to the cut end of ColorLINE segment. Apply pressure to end cap for one minute to ensure a strong bond.

Note: After cutting a custom length, any piece with black and red wires protruding from the original end cap will still light. Follow all of the manufacturer's recommendations when using Weld-On #16 adhesive. MSDS available at www.ipscorp.com.

12 VDC Power Supply capacity chart for ColorLINE

Power Supply/ Part # (each)	Input		Output		Maximum feet (Meter)
	Nominal Input Voltage	Input Current	Power Output	Output Current	All Colors
Self Contained 20 / 701680	120/240 V	0.3 A	20 W	1.5 A	8 (2.5)
Mod 60 / 701507-Mod	120/240 V	1.0 A	60 W	4.5 A	24 (7.3)
Mod 60-277 / 701507-Mod277	277-347 V	0.5 A	60 W	4.5 A	24 (7.3)
Quad 240* / 701494	120 V	3.6 A	240 W	4.5 A / Leg	96 (29.2)

Power used per Foot (Meter) in Watts: 1.8 (5.9)

*Quad 240 has four output legs; footages expressed are total (divide by four for footage per leg)

Installation Guide

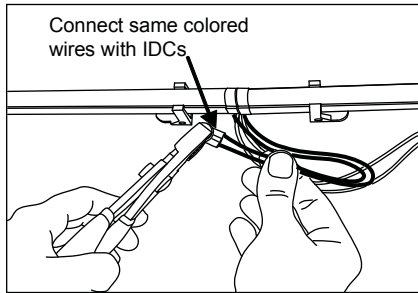

8. Connect ColorLINE Sections in a Chain: Cut wires to appropriate length and crimp same colored wires together using weather proof IDC Connectors. Connections must be RED-TO-RED and BLACK-TO-BLACK. Press connector with pliers until red button is fully depressed.

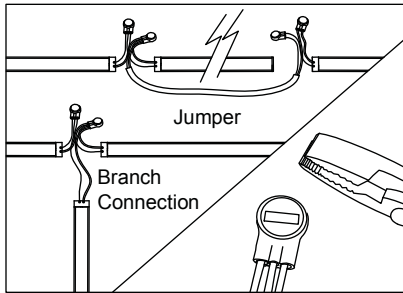

9. Creating jumpers or branch connections: If jumper or branch connection is required, cut wire or PLTC cable to desired length and use third port on IDC connector as necessary to make connections.

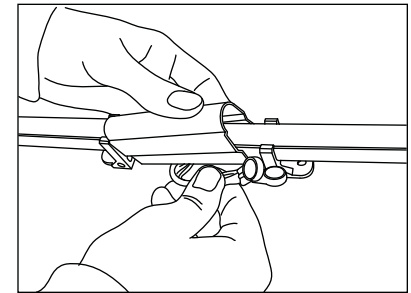

10. Snap covers into place: Tuck all loose wires at joints behind a joint cover. Extrusion and cover with a joint cover.

NOTE: Leave a 1/4" gap between sections if temperature during installation is below 40°F (4°C).

CORNERS TIP: To ease installation, install any optional mitered corners prior to mounting straight sections or making field cuts. Use two mounting clips on each side of the corner.

Extension of Power Supply Leads If longer lead wire from power supply to ColorLINE is needed, an extension can be used. Extension should be kept as short as possible (under 15 feet for 18 AWG UL Listed PLTC or under 50 feet for 14 AWG UL Listed PLTC).

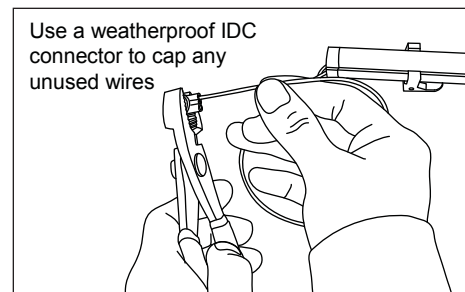
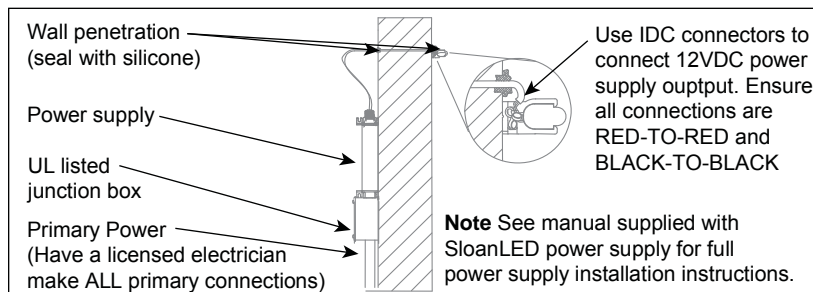

11. Connect ColorLINE chain to power supply: Connect wires from first section of ColorLINE chain to power supply wires using provided Insulation Displacement Connectors (IDC). Connections must be RED-TO-RED and BLACK-TO-BLACK. **CAUTION:** All primary power supply connections must be made by a licensed electrician.

12. Cap wires: Trim and cap all unused wires to prevent accidental shorting of wires. Do NOT connect RED wire to BLACK wire.

Troubleshooting:

Entire ColorLINE leg does not light after complete installation.	Check connection from power supply lead to first section of ColorLINE. Make sure polarity of connections made at the power supply lead, any jumper wire, and at the first section are correct. All connections must be RED-TO-RED and BLACK-TO-BLACK.
Still does not light.	Disconnect ColorLINE from power supply. Check output voltage of power supply using a voltmeter. The output voltage should be 12.0VDC ± 0.5VDC. If there is no output voltage, have a licensed electrician check input voltage. Make sure power supply is connected correctly and getting primary power. If power supply is connected properly and getting primary power and there is still no output voltage, replace power supply.
Still does not light.	If power supply is getting primary power, has the correct output, and no sections light, there may be a short in the secondary wiring. Check all connections and cap all loose wires.
The beginning of a leg lights, but the entire leg does not light or lights intermittently.	The primary cause of a portion of a ColorLINE leg not lighting or lighting intermittently is a bad connection or reverse polarity connection between the sections that light and the sections that don't light. Check this connection.
An entire power supply leg of ColorLINE is dim.	Ensure maximum number of feet has not been exceeded (see Power Supply Capacity Chart). Check secondary voltage. If voltage is below 11.5VDC, power supply leg may be overloaded.
One segment does not light, but all others in the leg light.	ColorLINE is designed so if one segment fails, it will not cause the entire leg to go out. If one segment does not light, but all others in the leg do, replace the entire section with a new one.

  UL file number: E21593



5725 Olivas Park Drive • Ventura, CA 93003 USA
805.676.3200 Fax: 805.676.3206
www.SloanLED.com • info@SloanLED.com

For customer service and technical support, contact
888.747.4LED (888.747.4533)

Disposal of your old product

Disposal of your old product

Your product is designed and manufactured with high quality materials and components, which can be recycled and reused.

Please inform yourself about the local separate collection system for electrical and electronic products, including those marked by the crossed-out wheel bin symbol.

Please act according to your local rules and do not dispose of your old products with your normal household waste.

EN



Mise au rebut d'un périphérique usagé

Votre appareil est conçu et fabriqué avec des matériaux et des composants de haute qualité qui peuvent être recyclés et réutilisés.

Renseignez-vous au sujet du système de collecte et de tri sélectif de votre région en ce qui concerne les produits électriques et électroniques, y compris ceux caractérisés par le symbole de la poubelle à roulettes marquée d'une croix.

Veuillez procéder conformément aux règlements locaux et ne pas mettre au rebut vos appareils usagés avec les ordures ménagères ordinaires.

F



Entsorgung Ihres alten Produkts

Ihr Produkt wurde mit qualitativ hochwertigen Materialien und Bauteilen entwickelt und gefertigt, die recycelt und wiederverwertet werden können. Bitte informieren Sie sich hinsichtlich der örtlichen, getrennten Sammelsysteme für Elektro- und Elektronikabfälle, einschließlich derer, die durch das durchgestrichene Rolltonnensymbol gekennzeichnet sind.

Bitte halten Sie sich an Ihre örtlichen Vorschriften und entsorgen Sie Ihr altes Produkt nicht mit Ihrem normalen Haushaltsmüll.

D



Smaltimento del vecchio prodotto

Il prodotto in dotazione è studiato e progettato con materiali e componenti di elevata qualità che possono essere riciclati e riutilizzati.

La preghiamo di informarsi sul sistema di raccolta differenziata in vigore localmente per i prodotti elettrici ed elettronici, compresi quelli contrassegnati con il simbolo del bidone con ruote crociato.

La preghiamo di attenersi alle norme locali e di non smaltire i vecchi prodotti insieme ai normali rifiuti domestici.

I



Oude producten opruimen

Uw product is ontworpen en gemaakt met materialen en componenten van hoge kwaliteit, die kunnen worden gerecycled en hergebruikt. Laat u informeren over het plaatselijke systeem voor het gescheiden opruimen van elektrische en elektronische producten, inclusief producten die zijn voorzien van het symbool met de doorgekruiste verrijdbare afvalbak.

Handel in overeenstemming met de plaatselijke voorschriften en gooi de oude producten niet weg bij het normale huishoudelijke afval.

NL



Eliminación del producto antiguo

Este producto ha sido diseñado y fabricado con materiales y componentes de alta calidad, que pueden ser reciclados y reutilizados. Por favor infórmese acerca del sistema de recolección independiente local de productos eléctricos y electrónicos, incluidos aquellos marcados con el símbolo del carrito contenedor tachado.

Por favor actúe de acuerdo a las leyes locales y no deseche los productos viejos con los desperdicios domésticos.

E



Descarte de seu produto antigo

Seu produto foi projetado e fabricado com materiais e componentes de alta qualidade, que podem ser reciclados e reutilizados.

Informe-se sobre seu sistema local de coleta separada para produtos elétricos e eletrônicos, incluindo aqueles marcados pelo símbolo de uma cesta de lixo sobre rodas riscada.

Aja de acordo com suas regras locais e não descarte seus produtos antigos juntamente com seu sistema de coleta domiciliar normal.

PT



Eski ürününüzün bertaraf edilmesi

Ürününüz, geri dönüşümü olan ve yeniden kullanılabilir yüksek kalite materyaller ve bileşenler ile dizayn edilerek üretilmiştir.

Çarpı atılmış dönüşüm kutusu sembolü işaretli olanlar dahil, elektrikli ve elektronik ürünler için yerel ayırma – toplama sistemi hakkında bilgi sahibi olunuz.

Yerel kurallara uygun olarak hareket ediniz ve eski ürünlerinizi, normal ev atıklarınız ile bertaraf etmeyiniz.

TR



5725 Olivas Park Drive • Ventura, CA 93003 USA
805.676.3200 Fax: 805.676.3206
www.SloanLED.com • info@SloanLED.com

For customer service and technical support, contact
888.747.4LED (888.747.4533)